

GEORGE T. DUNHAM  
SURVEYING & SUBDIVIDING  
DELAVER, WISCONSIN

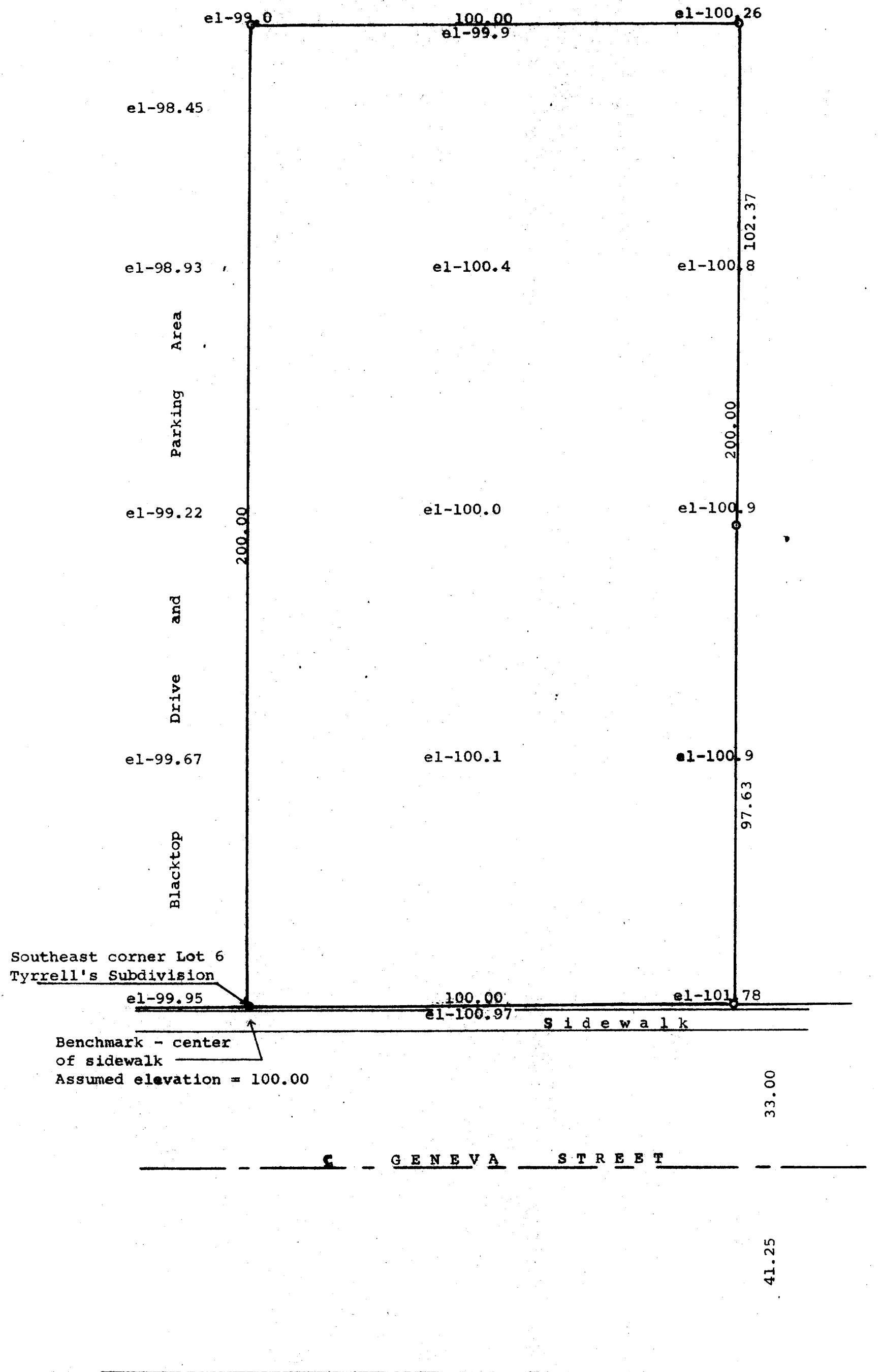

Scale - 1" = 20'

● = Concrete Monument  
○ = Iron Pipe

STATE OF WISCONSIN)  
WALWORTH COUNTY ) SS

I, George T. Dunham, Surveyor, do certify that I have surveyed the property described as follows,  
A parcel of land located in the Southwest 1/4 of Section 17, T 2 N, R 16 E, City of Delavan, Walworth County, Wisconsin, described as follows, to-wit: Beginning at the southeast corner of Lot 6 of Tyrrell's Subdivision; thence North along the east line of said Tyrrell's Subdivision 200.00 feet; thence East parallel with the north line of Geneva Street 100.00 feet; thence South parallel with the east line of said Tyrrell's Subdivision 200.00 feet; thence West along the north line of Geneva Street 100.00 feet to the place of beginning.  
and that the above plat is an accurate survey and a true representation thereof and correctly shows the exterior boundary lines and that there are no improvements located on said property.  
July 28, 1965

*George T. Dunham*  
George T. Dunham, Surveyor